

Folding skirts and folding top and bottom skirts

Folding skirt 75
for ES 50 to ES 80, and KOLOSS 60 and 90



Folding skirt 75, flat-rolled aluminium, 15x3mm, white or red/white, 750mm high, weight: 1.5kg/m

Folding skirt 150
for ES 60, ES 80, and KOLOSS

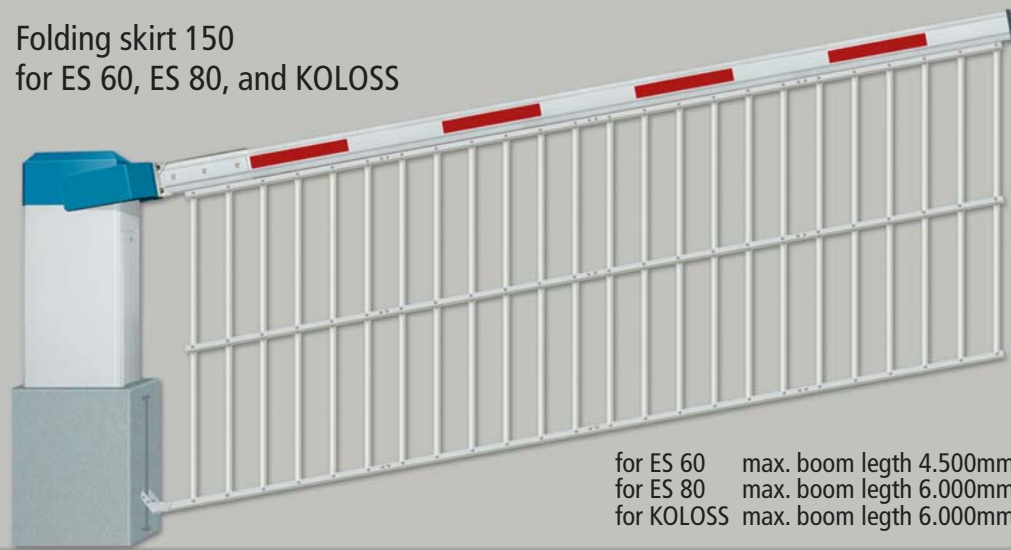

for ES 60 max. boom length 4.500mm
for ES 80 max. boom length 6.000mm
for KOLOSS max. boom length 6.000mm

Folding skirt 150, aluminium circular tubes, 20mm, white or red/white, 1,500mm high, weight: 4.5kg/m

Folding top and bottom skirt 150
for ES 60, ES 80, and KOLOSS

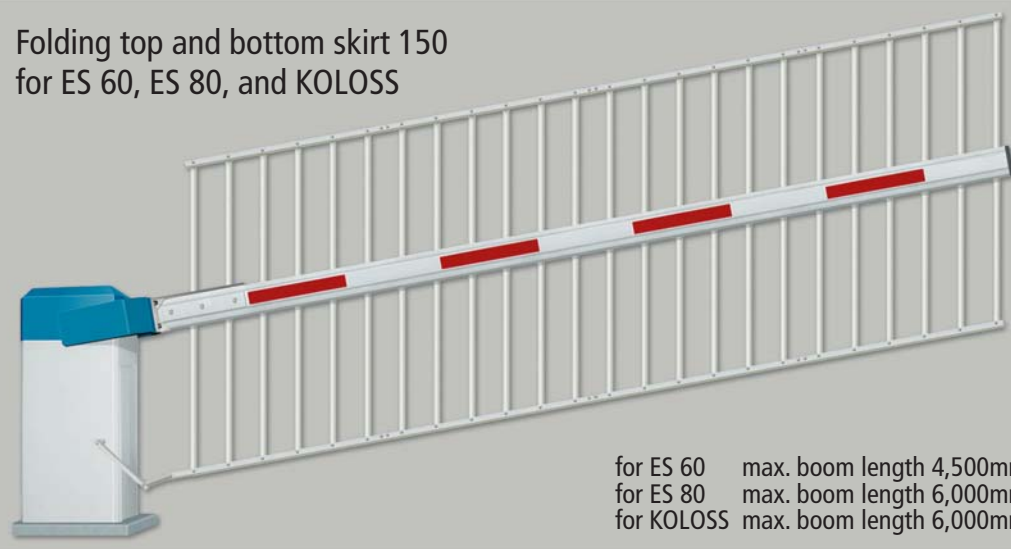

for ES 60 max. boom length 4,500mm
for ES 80 max. boom length 6,000mm
for KOLOSS max. boom length 6,000mm

Folding top and bottom skirt 150, aluminium circular tubes, 20mm, white or red/white, 1,500mm high, weight: 3.5kg/m

Barrier Accessories



Fixed support

Fixed support height adjustable - also with electromagnet -

Swinging support

Articulation kit for barrier boom

Operating devices

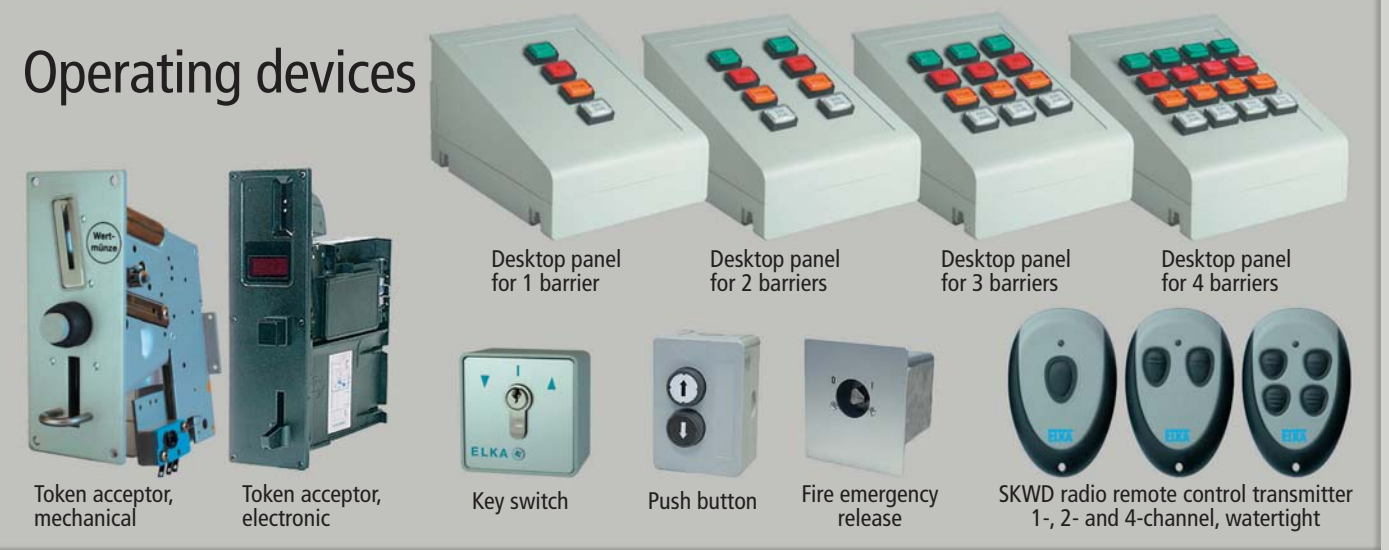

Desktop panel for 1 barrier

Desktop panel for 2 barriers

Desktop panel for 3 barriers

Desktop panel for 4 barriers

Token acceptor, mechanical

Token acceptor, electronic

Key switch

Push button

Fire emergency release

SKWD radio remote control transmitter 1-, 2- and 4-channel, watertight

Safety devices

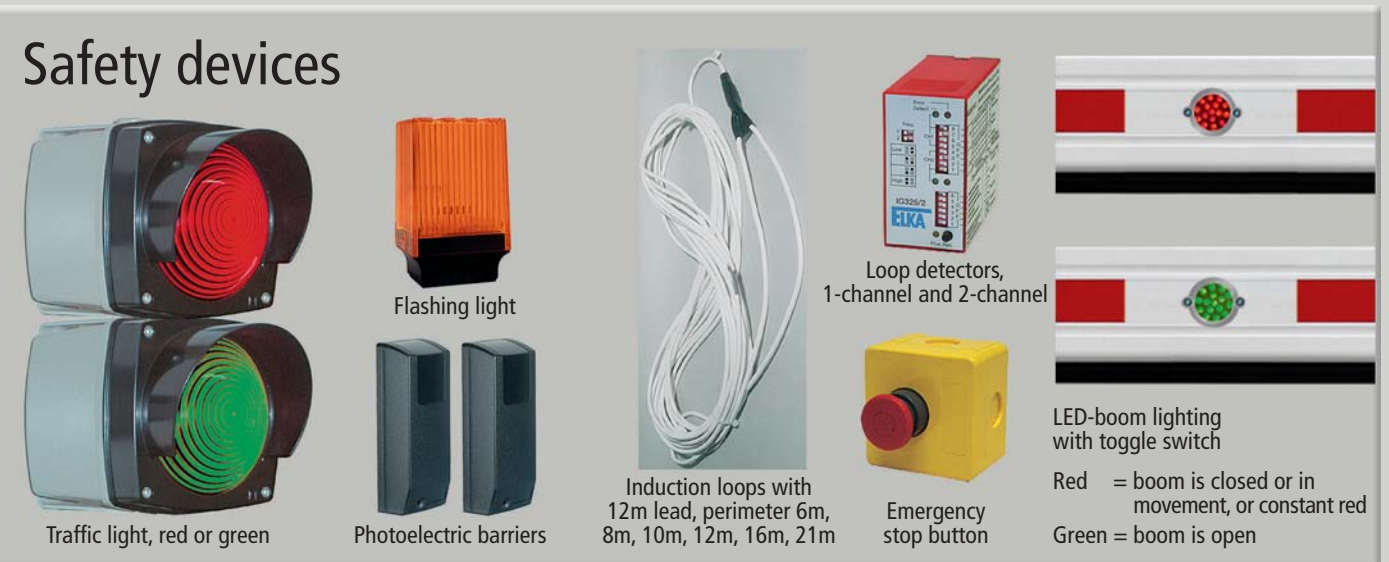

Traffic light, red or green

Photoelectric barriers

Induction loops with 12m lead, perimeter 6m, 8m, 10m, 12m, 16m, 21m

Emergency stop button

Loop detectors, 1-channel and 2-channel

LED-boom lighting with toggle switch
Red = boom is closed or in movement, or constant red
Green = boom is open

Barrier controller MO 63 for many million cycles



Basic details

- For ES 25 to ES 80 and KOLOSS 60 to KOLOSS 120
- Power supply 230V/50Hz

Obvious details

- Information is saved during current failure
- Automatic closure, programmable (0-300s)
- Pre-warning time OPEN, selectable (1.5s or 4s)
- Pre-warning time CLOSE, selectable (4s)
- One-button operation for serial switching or three-button operation for OPEN-STOP-CLOSE
- Flashing light and traffic light for status indication connectable
- Indication boom open/closed
- Socket for 434MHz radio remote control

Professional details

- TRIAC-relays for 5,000,000 movements
- Running time control
- Re-opening on obstacles
- Photo-cell connection for 6 photo-cells with patented testing function
- 12Vdc and 24Vdc supply for periphery equipment, 500mA, stabilised

Suitable for parking decks

- The barrier reverses immediately after a definite closing signal (selectable)
- After two opening signals the barrier closes after the second closing signal (selectable)

Induction loop for unobstructed entrance and exit

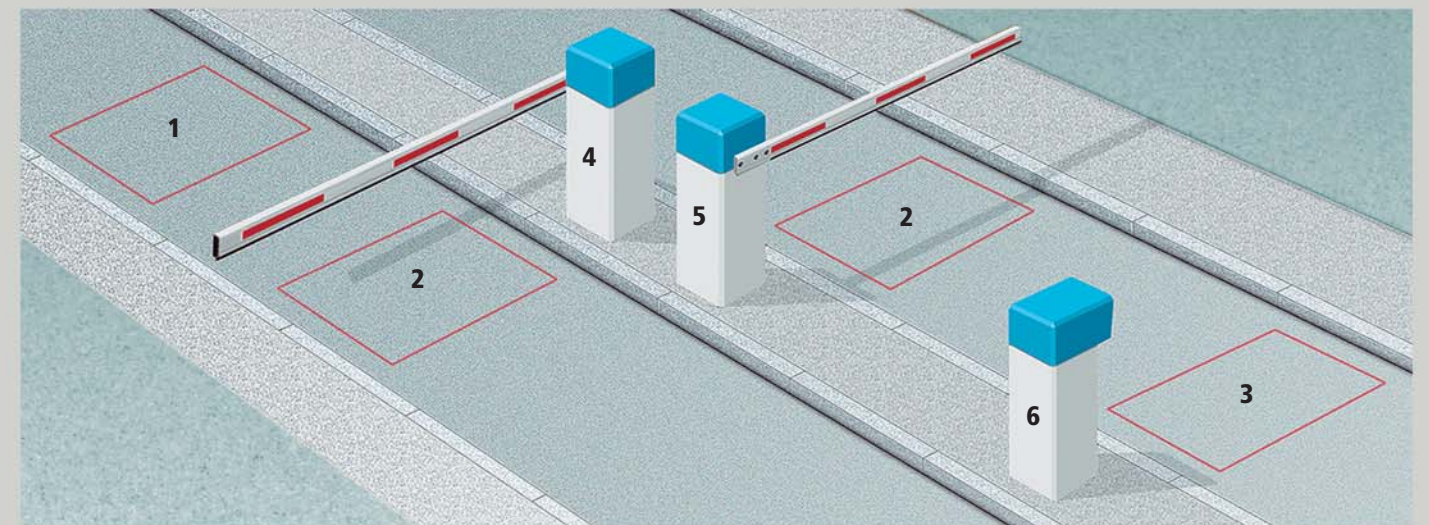

1 Induction loop for automatic opening 2 Induction loop for safety and closing 3 Induction loop indicating that a vehicle is present 4 Exit barrier 5 Entrance barrier 6 Entrance terminal with access control

4 Variants

- | | | | |
|--|--|--|---|
| <p>Variant 1
Access control e.g. with a key switch, when a vehicle is on the loop. Automatic exit with an opening loop. Safety of vehicles under the boom and closing of the barrier with induction loop.</p> | <p>Variant 2
Automatic entrance with an opening loop. Exit controls e.g. with tokens. Safety of vehicles under the boom and closing of the barrier with induction loop.</p> | <p>Variant 3
Access control e.g. with a key switch, when a vehicle is on the loop. Safety of vehicles under the boom and closing of the barrier with induction loops.</p> | <p>Variant 4
Access control e.g. with a key switch, when a vehicle is on the loop. Automatic exit with an opening loop. Safety of vehicles under the boom and closing of the barrier with induction loops.</p> |
|--|--|--|---|

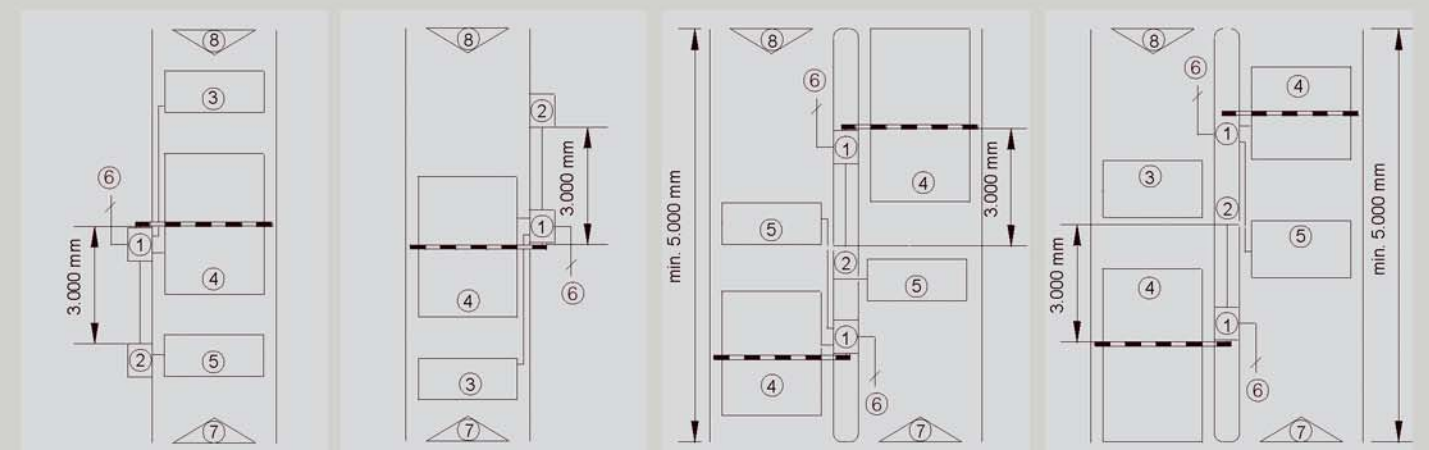

1 Barrier 2 Access control devices 3 Opening loop 4 Safety/closing loop 5 Presence loop 6 Mains supply 7 Entrance 8 Exit